

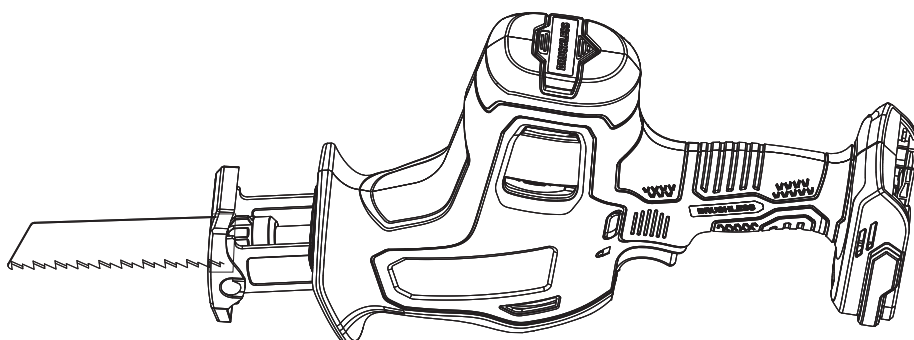

**X2** **18V** **Li-ion** **BRUSHLESS**™  
LITHIUM-ION

## CORDLESS COMPACT RECIPROCATING SAW



**CAUTION:** Before using this tool, please read this manual completely, and follow all operating safety measures.

- SAFETY
- ASSEMBLY
- OPERATION
- MAINTENANCE

**Senix Australia Pty Ltd.** 32/3 Westside Avenue, #Port Melbourne, Victoria, 3207  
For customer support, please call 1300 461 825 or email us at [info@senixtool.com](mailto:info@senixtool.com)

# TABLE OF CONTENTS

SAFETY & INTERNATIONAL SYMBOLS.....	2
SAFETY INSTRUCTIONS.....	3
KNOW YOUR UNIT .....	7
SPECIFICATIONS* .....	8
ASSEMBLY.....	8
OPERATION.....	9
MAINTENANCE.....	11
TROUBLESHOOTING.....	12



Indoor use only. Only use battery charger indoors.



Class II equipment (Charger).



RCM mark

## SAFETY & INTERNATIONAL SYMBOLS

Explanation of Safety & International Symbols describes safety and international symbols and pictographs that may appear on this product. Read the operator's manual for complete safety, assembly, operating and maintenance and repair information.



Caution / Warning.



To reduce the risk of injury, user must read instruction manual.



Always wear eye protection, ear protection and head protection meeting ANSI Z87.1 standards.



Wear protective gloves.



Wear sturdy, non-slip footwear.



Do not use in rain or wet conditions.



Do not dispose of battery packs in rivers or immerse in water.



Do not dispose of battery packs in fire. They will explode and cause injury.



Keep bystanders a safe distance away from the work area.

# SAFETY INSTRUCTIONS

## ORIGINAL INSTRUCTIONS

### GENERAL POWER TOOL SAFETY WARNINGS



#### WARNING:

Read all safety warnings, instructions, illustrations, and specifications, provided with this power tool.

*Failure to follow all instructions listed below may result in electric shock, fire, and/or serious injury.*

**Save all warnings and instructions for future reference.**

*The term "power tool" in the warnings refers to your mains-operated (corded) power tool or battery-operated (cordless) power tool.*

#### 1) Work Area Safety

- a. **Keep the work area clean and well-lit.** *Cluttered or dark areas invite accidents.*
- b. **Do not operate power tools in explosive atmospheres, such as in the presence of flammable liquids, gases, or dust.** *Power tools create sparks that may ignite dust or fumes.*
- c. **Keep children and bystanders away while operating a power tool.** *Distractions can cause you to lose control.*

#### 2) Electrical Safety

- a. **Power tool plugs must match the outlet. Never modify the plug in any way. Do not use any adapter plugs with earthed (grounded) power tools.** *Unmodified plugs and matching outlets will reduce the risk of electric shock.*
- b. **Avoid body contact with earthed or grounded surfaces, such as pipes, radiators, ranges, and refrigerators.** *There is an increased risk of electric shock if your body is earthed or grounded.*
- c. **Do not expose power tools to rain or wet conditions.** *Water entering a power tool will increase the risk of electric shock.*
- d. **Do not abuse the cord. Never use the cord for carrying, pulling, or unplugging the power tool. Keep the cord away from heat, oil, sharp edges, or moving parts.** *Damaged or entangled cords increase the risk of electric shock.*

- e. **When operating a power tool outdoors, use an extension cord suitable for outdoor use.** *The use of a cord suitable for outdoor use reduces the risk of electric shock.*
- f. **If operating a power tool in a damp location is unavoidable, use a residual current device (RCD) protected supply.** *The use of an RCD reduces the risk of electric shock.*

#### 3) Personal Safety

- a. **Stay alert, watch what you are doing, and use common sense when operating a power tool. Do not use a power tool while you are tired or under the influence of drugs, alcohol, or medication.** *A moment of inattention while operating power tools may result in serious personal injury.*
- b. **Use personal protective equipment. Always wear eye protection.** *Protective equipment such as a dust mask, non-skid safety shoes, hard hats, or hearing protection used for appropriate conditions will reduce personal injuries.*
- c. **Prevent unintentional starting. Ensure the switch is in the off-position before connecting to a power source and/or battery pack, picking up, or carrying the tool.** *Carrying power tools with your finger on the switch or energizing power tools that have the switch on invites accidents.*
- d. **Remove any adjusting key or wrench before turning the power tool on.** *A wrench or a key left attached to a rotating part of the power tool may result in personal injury.*
- e. **Do not overreach. Keep proper footing and balance at all times.** *This enables better control of the power tool in unexpected situations.*
- f. **Dress properly. Do not wear loose clothing or jewelry. Keep your hair and clothing away from moving parts.** *Loose clothes, jewelry, or long hair can be caught in moving parts.*
- g. **If devices are provided for the connection of dust extraction and collection facilities, ensure these are connected and properly used.** *The use of dust collection can reduce dust-related hazards.*
- h. **Do not let familiarity gained from the frequent use of tools allow you to become complacent and ignore tool safety principles.** *A careless action can*

cause severe injury within a fraction of a second.

#### 4) Power Tool Use and Care

- a. **Do not force the power tool. Use the correct power tool for your application.** *The correct power tool will do the job better and safer at the rate for which it was designed.*
- b. **Do not use the power tool if the switch does not turn on and off.** *Any power tool that cannot be controlled with the switch is dangerous and must be repaired.*
- c. **Disconnect the plug from the power source and/or remove the battery pack, if detachable, from the power tool before making any adjustments, changing accessories, or storing power tools.** *Such preventive safety measures reduce the risk of starting the power tool accidentally.*
- d. **Store idle power tools out of the reach of children and do not allow persons unfamiliar with the power tool or these instructions to operate the power tool.** *Power tools are dangerous in the hands of untrained users.*
- e. **Maintain power tools and accessories. Check for misalignment or binding of moving parts, breakage of parts, and any other condition that may affect the power tool's operation. If damaged, have the power tool repaired before use.** *Many accidents are caused by poorly maintained power tools.*
- f. **Keep cutting tools sharp and clean.** *Properly maintained cutting tools with sharp cutting edges are less likely to bind and are easier to control.*
- g. **Use the power tool, accessories, tool bits, etc. by these instructions, taking into account the working conditions and the work to be performed.** *Use of the power tool for operations different from those intended could result in a hazardous situation.*
- h. **Keep handles and grasping surfaces dry, clean, and free from oil and grease.** *Slippery handles and grasping surfaces do not allow for safe handling and control of the tool in unexpected situations.*

#### 5) Battery Tool Use and Care

- a. **Recharge only with the charger specified by the manufacturer.** *A charger that is suitable for one type of battery pack may create a risk of fire when used with*

*another battery pack.*

- b. **Use power tools only with specifically designated battery packs.** *Use of any other battery packs may create a risk of injury and fire.*
- c. **When the battery pack is not in use, keep it away from other metal objects, such as paper clips, coins, keys, nails, screws, or other small metal objects that can make a connection from one terminal to another.** *Shorting the battery terminals together may cause burns or a fire.*
- d. **Under abusive conditions, liquid may be ejected from the battery; avoid contact.** *If contact accidentally occurs, flush with water. If liquid contacts the eyes, additionally seek medical help. Liquid ejected from the battery may cause irritation or burns.*
- e. **Do not use a battery pack or tool that is damaged or modified.** *Damaged or modified batteries may exhibit unpredictable behavior resulting in fire, explosion, or risk of injury.*
- f. **Do not expose a battery pack or tool to fire or excessive temperature.** *Exposure to fire or temperature above 130 °C may cause an explosion.*
- g. **Follow all charging instructions and do not charge the battery pack or tool outside the temperature range specified in the instructions.** *Charging improperly or at temperatures outside the specified range may damage the battery and increase the risk of fire.*



### WARNING!

Use only SENIX X2 batteries (B40X2/B50X2/B60X2/B80X2) and chargers (CHX2-EU/CHQX2/CHQX2-M-EU/CHDX2-M-EU).

#### 6) Service

- a. **Have your power tool serviced by a qualified repair person using only identical replacement parts.** *This will ensure that the safety of the power tool is maintained.*
- b. **Never service damaged battery packs.** *Service of battery packs should only be performed by the manufacturer or authorized service providers.*

## SAFETY WARNINGS FOR RECIPROCATING SAWS

- a. **Hold the power tool by insulating gripping surfaces when operating where the cutting accessory may contact hidden wiring.** *Cutting accessory contacting a "live" wire may make exposed metal parts of the power tool "live" and could give the operator an electric shock.*
- **Reciprocating saws with an integral battery shall be equipped with an isolation device to prevent the risk of injury from mechanical hazards during user maintenance that:**
  - *Ensures a reliable disconnection of at least one pole of the battery from the relevant load(s);*
  - *Has a reliable mechanical link between the manual control and the disconnecting element(s);*
  - *Is equipped with an unambiguous indication of the state of the disconnection device which corresponds to each position of its manual control (actuator);*
  - *Protects against accidental reconnection.*
- b. **Use clamps or another practical way to secure and support the workpiece to a stable platform.** *Holding the workpiece by hand or against your body leaves it unstable and may lead to loss of control.*
- c. **Keep hands away from moving parts.** *Never place your hands near the cutting area.*
- d. **Use extra caution when cutting overhead and pay particular attention to overhead wires which may be hidden from view.** *Anticipate the path of falling branches and debris ahead of time.*
- e. **Do not operate this tool for long periods.** *Vibration caused by the operating action of this tool may cause permanent injury to fingers, hands, and arms. Use gloves to provide extra cushion, take frequent rest periods, and limit the daily time of use.*
- f. **Avoid prolonged contact with dust from power sanding, sawing, grinding, drilling, and other construction activities. Wear protective clothing and wash exposed areas with soap and water.** *Allowing dust to get into your mouth, and eyes, or lay on the skin may promote the absorption of harmful chemicals.*
- g. **Avoid unintentional starting.** *Prepare to begin work before turning on the tool.*
- h. **Do not lay the tool down until it has completely stopped.** *Moving parts can grab the surface and pull the tool out of your control.*
- i. **When using a handheld power tool, maintain a firm grip on the tool with both hands to resist starting torque.**
- j. **Do not leave the tool unattended when the battery pack is connected.** *Turn off the tool, and remove the battery pack before leaving.*
- k. **This product is not a toy. Keep it out of reach of children.**

## SAFETY WARNING FOR BATTERY PACK AND BATTERY CHARGER

- Recharge only with the charger specified by the manufacturer. A charger that is suitable for one type of battery pack may create a risk of fire when used with another battery pack.
- Use the equipment only with specifically designated battery packs. Use of any other battery packs may create a risk of injury and fire.
- When the battery pack is not in use, keep it away from other metal objects, such as paper clips, coins, keys, nails, screws, or other small metal objects, that can make a connection from one terminal to another. Shorting the battery terminals together may cause burns or a fire.
- Under abusive conditions, liquid may be ejected from the battery; avoid contact. If contact accidentally occurs, flush with water. If liquid contacts the eyes, seek additional medical help. Liquid ejected from the battery may cause irritation or burns. (This advice is considered correct for conventional NiMh, NiCd, lead acid, and lithium-ion cell types. If this advice is incorrect for a cell design that differs from these, then the correct advice may be substituted.)
- Do not use a battery pack or equipment that is damaged or modified. Damaged or modified batteries may exhibit unpredictable behavior resulting in fire, explosion, or risk of injury.
- Do not expose a battery pack or equipment to fire or excessive temperature. Exposure to fire or temperature above 130°C may cause an explosion.
- Follow all charging instructions and do not charge the battery pack or equipment outside of the temperature range specified

in the instructions. Charging improperly or at temperatures outside of the specified range may damage the battery and increase the risk of fire.

- Do not modify or attempt to repair the equipment or the battery pack (as applicable) except as indicated in the instructions for use and care.

## **VIBRATION + NOISE REDUCTION**

To reduce the impact of noise and vibration emission, limit the time of operation, use low-vibration and low-noise operating modes as well as wear personal protective equipment. Consider the following points to minimize the vibration and noise exposure risks.

- Only use the product as intended by its design and these instructions.
- Ensure that the product is in good condition and well-maintained.
- Use correct attachments for the product and ensure they are in good condition.
- Keep a tight grip on the handles/grip surface.
- Maintain this product by these instructions and keep it well-lubricated (where appropriate).
- Plan your work schedule to spread any high-vibration tool use across a longer period.

## **EMERGENCY**

- Familiarize yourself with the use of this product using this instruction manual. Memorize the safety directions and follow them to the letter. This will help to prevent risks and hazards.
- Always be alert when using this product, so that you can recognize and handle risks early. Fast intervention can prevent serious injury and damage to property.
- Switch off the product and remove the battery pack if there are malfunctions. Have the product checked by a qualified professional and repaired, if necessary before you operate it again.

## KNOW YOUR UNIT

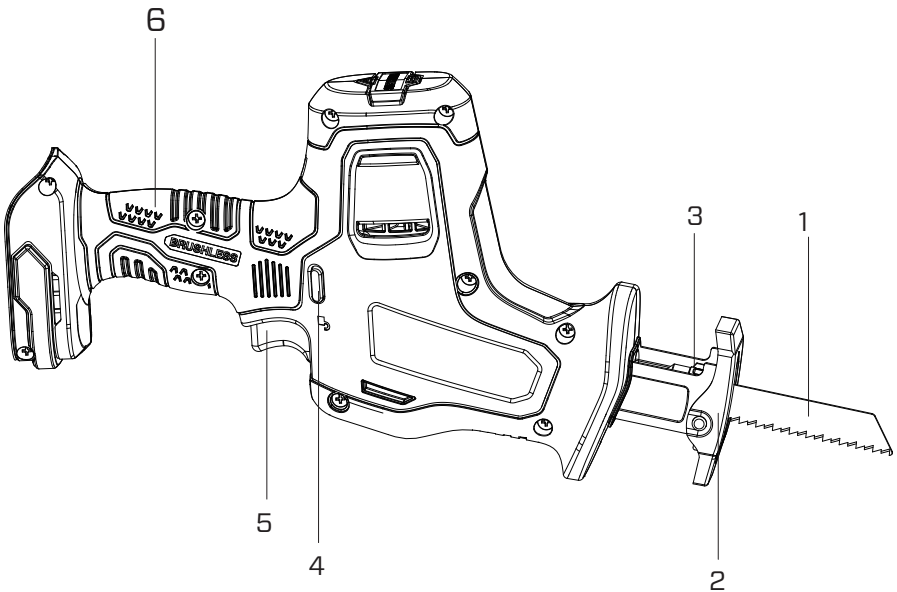

### APPLICATIONS

Model: PSRX2-M2-EU

As a cordless reciprocating saw:  
Cutting wood, metal, and plastic materials.

1	Saw Blade
2	Pivoting Shoe
3	Blade Clamp
4	Trigger Lock
5	Variable Speed Trigger
6	Overmold Grip Area

# SPECIFICATIONS\*

Model	PSRX2-M2-EU
Rated Voltage	18 V $\square$ (20 V $\square$ Max*)
No Load Speed	0 - 3000 SPM
Stroke Length	22 mm
Cutting Capacity	Wood: 255 mm Mild Steel: 130 mm
Weight (Without battery)	1.71 kg

\*20V Max battery, maximum initial battery voltage (measured without a workload) is 20V. The nominal voltage is 18V.

## ASSEMBLY

1. Unpack all parts and lay them on a flat, stable surface.
2. Remove all packing materials and shipping devices, if applicable.
3. The scope of delivery varies depending on the country and purchased variant.

Model PSRX2-M2-EU

- Reciprocating saw x1
  - Saw Blade x1
  - Battery pack x1
  - Charger x1
  - Storage Bag x1
  - Instruction manual x1
4. If you find that parts are missing or show damage, do not use the product and contact your dealer. Using an incomplete or damaged product represents a hazard to people and property.
  5. Ensure that you have all the accessories and tools needed for assembly and operation. This also includes suitable personal protective equipment.



### WARNING:



Wear protective gloves for this assembly work and always lay the product on a flat and stable surface while assembling. Follow the assembly instructions step-by-step

EN - 8

and use the pictures provided as a visual guide to easily assemble the product! Do not insert the battery pack before the power tool is completely assembled or adjusted!

## BLADE



### WARNING:

Never attach a bent blade or operate the saw with a loose blade.

#### To install:

Twist open the clamp and insert the blade as far as it will go. Once released, the blade will be firmly held in place. Pull the blade to make sure it is securely clamped.

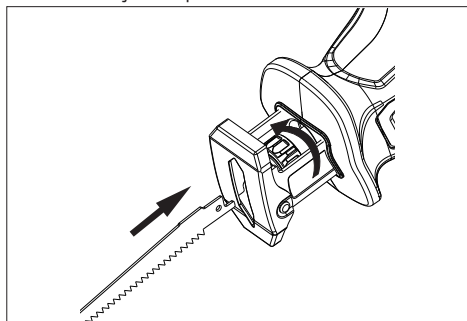

#### To remove:

Twist open the clamp and pull the blade out.



### WARNING:

The blade may be hot after use. Make sure it is completely cooled down before touching it.

## BATTERY PACK



### NOTE:

Prior to installation, lock the trigger using the trigger lock to avoid an unintentional start.

#### To install:

Align and slide the battery pack to the docking port until it is locked in place.



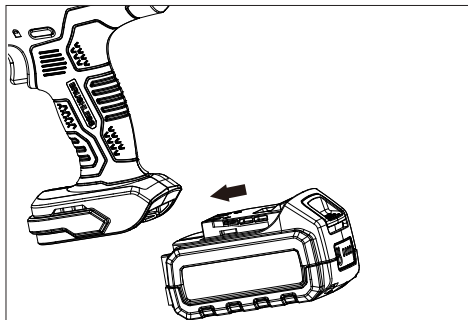

#### To remove:

Press the unlock button and slide the battery pack out.



#### NOTE:

If necessary, refer to the manuals for the charger and battery pack for more details about how to charge and other information.

## OPERATION



#### WARNING:

Always wear eye, hearing, and hand protection to reduce the risk of injury when operating the tool. Keep all parts of your body away from the rotating bit.



#### WARNING:

Before cutting any type of material, be sure it is firmly clamped to prevent slipping.

## WORKPIECE AND WORK AREA SET UP

1. Designate a work area that is clean and well-lit. The work area must not allow children or pets to prevent distraction and injury.
2. Secure loose workpieces using a vise or clamps to prevent movement while working.
3. There must not be objects, such as utility lines, nearby that will present a hazard while working. This is especially critical for plunge cuts.

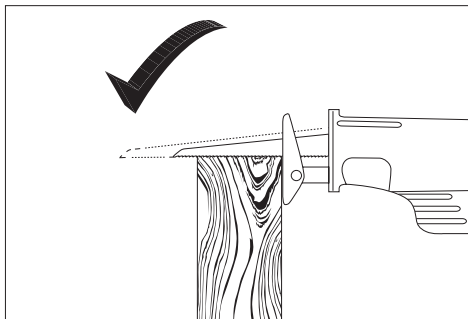
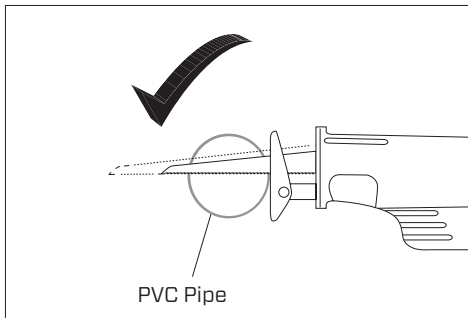

4. Blade breakage may occur if the blade does not extend past the shoe and the workpiece during the cut. A properly sized workpiece is important for operation



#### WARNING:

To prevent injury, do not work on materials thicker than the minimum blade extension at their maximum thickness. Blade tip can strike the workpiece and may shatter.

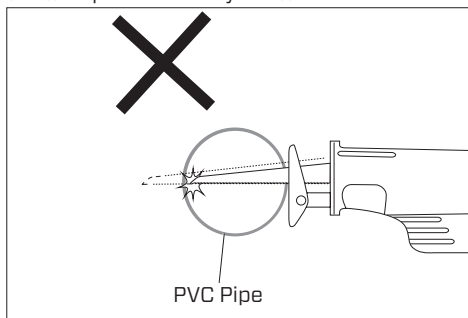

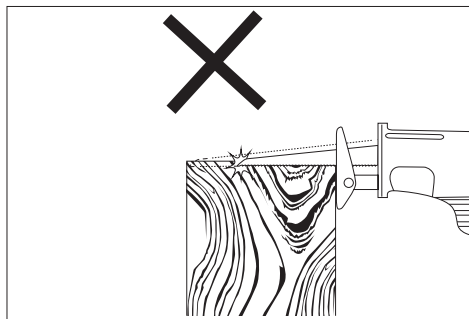

## SWITCHING ON/OFF

Switch the trigger lock off, then squeeze the trigger to start the saw.

The saw stops once the trigger is released. When the tool is not in use, turn the trigger lock to the "Lock" position in case of an unintentional start.

## GENERAL INSTRUCTIONS FOR USE

1. Grip the saw firmly with both hands and rest the front of the pivoting shoe on the workpiece with the blade above the work.
2. Rest the pivoting shoe on the workpiece, making sure the blade is not touching the workpiece.
3. Allow the saw to reach desired speed before guiding it into the workpiece.



### NOTE:

Use faster speed when cutting softer materials. Use a slower speed when cutting harder materials.

4. Do not force the cut. Follow the cut and maintain a smooth motion.
5. Keep the pivoting shoe firmly against the workpiece at all times. Never bend the blade.
6. Saw shuts down when the blade is jammed. Remove the blade from the cut and restart.
7. Replace the blade when it becomes dull.
8. To prevent accidents, turn off the tool and lock the trigger, and remove its battery pack after use. Clean, then store the tool indoors out of children's reach.



### WARNING:

Prevent dust accumulation at the workplace. Dust can easily ignite.

## PLUNGE CUTTING



### NOTE:

Plunge cut into plywood, sheetrock, and thin board panels. Do not attempt to plunge cut into thick hardwood or metal panels.

1. Mark the cut line on the workpiece.
2. Place pivoting shoe on the workpiece with the blade parallel to the cut line, and not touching the workpiece.



### WARNING:

To prevent serious injury due to kickback, do not start a plunge cut with the saw blade touching the workpiece.

3. Start the saw and allow it to reach full speed.
4. Guide the blade into the workpiece. Slowly tilt the saw until the blade is perpendicular to the workpiece.
5. Maintain the smooth cut along the line to complete the cut.

## METAL CUTTING

1. Install a blade specially designed for metal cutting.
2. Coat the cutting surface with cutting oil to prevent the blade from overheating.
3. Follow chapter "GENERAL INSTRUCTION FOR USE".

## OVERHEAT PROTECTION

When the tool/battery is overheated, the tool stops automatically. In this situation, let the power tool/battery cool before turning the tool on again.

## OVERDISCHARGE PROTECTION

When the battery capacity is below a safe level, the tool stops automatically. If this occurs, remove the battery from the tool and charge the battery.

## MAINTENANCE



### WARNING:

Only perform cleaning and maintenance work according to these instructions!

All further work must be performed by a qualified specialist!



### WARNING:

TO PREVENT SERIOUS INJURY FROM ACCIDENTAL OPERATION:

Make sure the trigger is locked and the battery pack is removed before performing any procedure in this section.

TO PREVENT SERIOUS INJURY FROM TOOL FAILURE:

Do not use damaged equipment.

If abnormal noise or vibration occurs, have the problem corrected before further use.

There are no user-serviceable parts in your power tool.

If any of the following conditions are found, stop using it and send it to the authorized service center for repair:

- Leaking, swollen, or cracked battery pack
- Loose hardware
- Misalignment or binding of accessories.
- Cracked or broken parts.
- Any other condition that may affect its safe operation.

## CLEANING

1. Clean dust and debris from air vents.
2. Keep the handle clean, dry, and free of oil or grease.
3. Make sure the clamp is free of chips and sawdust.
4. Remove stubborn dirt from housing with high-pressure air (max. 3 bar).



### NOTE:

Do not use chemical, alkaline, abrasive, or other aggressive detergents or disinfectants to clean this product as they might be harmful to its surfaces.

## STORAGE

1. Clean thoroughly as described above.
2. Store in a dark, dry, frost-free, and well-ventilated area that is inaccessible to

children.

3. Use the original package for storage or cover it with a suitable cloth to protect it against dust.



### NOTE:

To prolong battery life, store the battery pack separately from the tool in a 30% - 50% charged condition. It's recommended to have your battery pack charged at least every 6 months.

## TRANSPORTATION

1. Only carry by its handle.
2. Remove or cover the blade during transportation.
3. Protect from any heavy impact or strong vibrations which may occur during transportation in vehicles.
4. Secure to prevent it from slipping or falling over.

## DISPOSAL

Waste products should not be disposed of with household waste. Please recycle where facilities exist. Check with your local authority or retailer for recycling advice. Chips or sawdust may be produced by the tool during operation, users should clean these objects to protect the environment.



Electrical products should not be discarded with household products. Used electrical products must be collected separately and disposed of at collection points provided for this purpose. Talk with your local authorities or dealer for advice on recycling.

# TROUBLESHOOTING

Suspected malfunctions are often due to causes that the users can fix themselves. Therefore, check the product using this section. In most cases, the problem can be solved quickly.

PROBLEM	POSSIBLE CAUSE	SOLUTION
The product does not start.	The variable speed trigger is locked.	Unlock the variable speed trigger by releasing the trigger lock.
	The battery pack is not properly attached.	Attach properly.
	The battery pack is completely discharged.	Charge the battery pack.
The tool operates slowly.	Applying too much force to the tool while in use.	Allow the tool to perform the work with little force.
	Battery charge is too low.	Charge the battery pack.
Performance decreases over time.	The blade is dull or damaged.	Keep blades sharp. Replace with a new one if necessary.
	Battery pack reaches its life cycle.	Replace with a new one.
Excessive noise.	Internal damage or wear. (Bearings, for example.)	Have technician service tool.
Overheating	Forcing the tool to work too fast.	Allow the tool to work at its maximum designated rate.
	Blade dull or damaged, requiring additional time to complete work.	Keep blades sharp. Replace as needed.
	Blocked motor housing vents.	Blow the dust out of the motor using compressed air.