

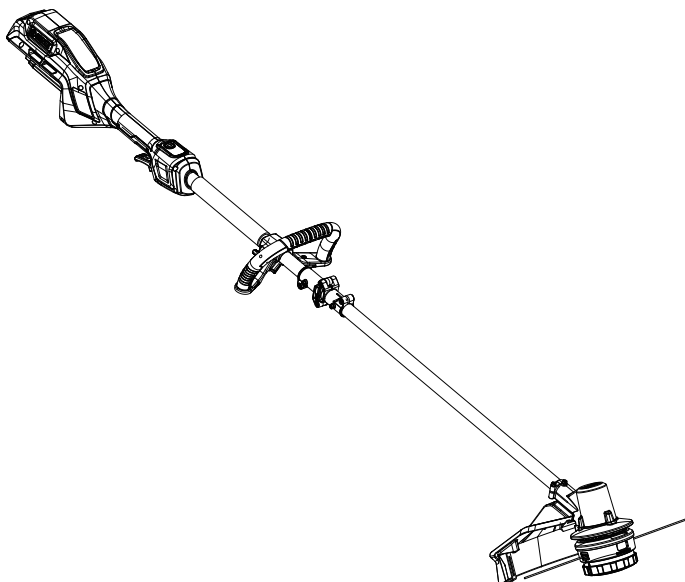

## CORDLESS LINE TRIMMER



**CAUTION:** Before using this tool, please read this manual completely, and follow all operating safety measures.

- SAFETY
- ASSEMBLY
- OPERATION
- MAINTENANCE

**Senix Australia Pty Ltd.** 32/3 Westside Avenue, #Port Melbourne, Victoria, 3207  
For customer support, please call 1300 461 825 or email us at [info@senixtool.com](mailto:info@senixtool.com)

# TABLE OF CONTENTS

|                                     |    |
|-------------------------------------|----|
| SAFETY & INTERNATIONAL SYMBOLS..... | 2  |
| SAFETY INSTRUCTIONS.....            | 3  |
| KNOW YOUR UNIT.....                 | 8  |
| SPECIFICATIONS.....                 | 9  |
| ASSEMBLY.....                       | 9  |
| OPERATION.....                      | 14 |
| MAINTENANCE.....                    | 16 |
| TROUBLESHOOTING.....                | 18 |

## SAFETY & INTERNATIONAL SYMBOLS

The following table depicts and describes safety symbols that may appear on this product. Read, understand and follow all instructions on the machine before attempting to assemble and operate.



Caution / Warning.



To reduce the risk of injury, user must read instruction manual.



Wear eye protection.



Wear hearing protection.



Wear a dust mask.



Do not use in rain or wet conditions.



Wear sturdy, non-slip footwear.



Wear protective gloves.



WARNING - Beware of thrown objects.



WARNING - The distance between the machine and bystanders shall be at least 15m.



Do not use metal blades.



Beware of blade thrust.



Do not dispose of battery packs in rivers or immerse in water.



Do not dispose of battery packs in fire. They will explode and cause injury.



Keep bystanders a safe distance away from the work area.



Indoor use only. Only use battery charger indoors.



WARNING - Disconnect battery before maintenance.



Max rotation speed.



16" (40.6 cm).



Guaranteed sound power level



The product complies with the applicable European directives and an evaluation method of conformity for these directives was done.



RCM Mark

# SAFETY INSTRUCTIONS

## GENERAL POWER TOOL SAFETY WARNINGS



### WARNING!

**Read all safety warnings, instructions, illustrations and specifications provided with this power tool.** *Failure to follow all instructions listed below may result in electric shock, fire and/or serious injury.*

**Save all warnings and instructions for future reference.**

*The term "power tool" in the warnings refers to your mains-operated (corded) power tool or battery-operated (cordless) power tool.*

#### 1) Work area safety

- a. **Keep work area clean and well lit.** *Cluttered or dark areas invite accidents.*
- b. **Do not operate power tools in explosive atmospheres, such as in the presence of flammable liquids, gases or dust.** *Power tools create sparks which may ignite the dust or fumes.*
- c. **Keep children and bystanders away while operating a power tool.** *Distractions can cause you to lose control.*

#### 2) Electrical safety

- a. **Power tool plugs must match the outlet. Never modify the plug in any way. Do not use any adapter plugs with earthed (grounded) power tools.** *Unmodified plugs and matching outlets will reduce risk of electric shock.*
- b. **Avoid body contact with earthed or grounded surfaces, such as pipes, radiators, ranges and refrigerators.** *There is an increased risk of electric shock if your body is earthed or grounded.*
- c. **Do not expose power tools to rain or wet conditions.** *Water entering a power tool will increase the risk of electric shock.*
- d. **Do not abuse the cord. Never use the cord for carrying, pulling or unplugging the power tool. Keep cord away from heat, oil, sharp edges or moving parts.** *Damaged or entangled cords increase the risk of electric shock.*
- e. **When operating a power tool outdoors, use an extension cord suitable for outdoor use.** *Use of a cord suitable for*

*outdoor use reduces the risk of electric shock.*

- f. **If operating a power tool in a damp location is unavoidable, use a residual current device (RCD) protected supply.** *Use of an RCD reduces the risk of electric shock.*
- #### 3) Personal safety
- a. **Stay alert, watch what you are doing and use common sense when operating a power tool. Do not use a power tool while you are tired or under the influence of drugs, alcohol or medication.** *A moment of inattention while operating power tools may result in serious personal injury.*
  - b. **Use personal protective equipment. Always wear eye protection.** *Protective equipment such as a dust mask, non-skid safety shoes, hard hat or hearing protection used for appropriate conditions will reduce personal injuries.*
  - c. **Prevent unintentional starting. Ensure the switch is in the off-position before connecting to power source and/or battery pack, picking up or carrying the tool.** *Carrying power tools with your finger on the switch or energising power tools that have the switch on invites accidents.*
  - d. **Remove any adjusting key or wrench before turning the power tool on.** *A wrench or a key left attached to a rotating part of the power tool may result in personal injury.*
  - e. **Do not overreach. Keep proper footing and balance at all times.** *This enables better control of the power tool in unexpected situations.*
  - f. **Dress properly. Do not wear loose clothing or jewellery. Keep your hair and clothing away from moving parts.** *Loose clothes, jewellery or long hair can be caught in moving parts.*
  - g. **If devices are provided for the connection of dust extraction and collection facilities, ensure these are connected and properly used.** *Use of dust collection can reduce dust-related hazards.*
  - h. **Do not let familiarity gained from frequent use of tools allow you to become complacent and ignore tool safety principles.** *A careless action can cause severe injury within a fraction of a second.*

#### 4) Power tool use and care

- a. **Do not force the power tool. Use the correct power tool for your application.**  
*The correct power tool will do the job better and safer at the rate for which it was designed.*
  - b. **Do not use the power tool if the switch does not turn it on and off. Any power tool that cannot be controlled with the switch is dangerous and must be repaired.**
  - c. **Disconnect the plug from the power source and/or remove the battery pack, if detachable, from the power tool before making any adjustments, changing accessories, or storing power tools.** *Such preventive safety measures reduce the risk of starting the power tool accidentally.*
  - d. **Store idle power tools out of the reach of children and do not allow persons unfamiliar with the power tool or these instructions to operate the power tool.** *Power tools are dangerous in the hands of untrained users.*
  - e. **Maintain power tools and accessories. Check for misalignment or binding of moving parts, breakage of parts and any other condition that may affect the power tool's operation. If damaged, have the power tool repaired before use. Many accidents are caused by poorly maintained power tools.**
  - f. **Keep cutting tools sharp and clean.** *Properly maintained cutting tools with sharp cutting edges are less likely to bind and are easier to control.*
  - g. **Use the power tool, accessories and tool bits etc. in accordance with these instructions, taking into account the working conditions and the work to be performed. Use of the power tool for operations different from those intended could result in a hazardous situation.**
  - h. **Keep handles and grasping surfaces dry, clean and free from oil and grease.** *Slippery handles and grasping surfaces do not allow for safe handling and control of the tool in unexpected situations.*
- 5) Battery Tool Use And Care**
- a. **Recharge only with the charger specified by the manufacturer.** *A charger that is suitable for one type of battery pack may create a risk of fire when used with another battery pack.*
  - b. **Use power tools only with specifically designated battery packs.** *Use of any other battery packs may create a risk of injury and fire.*
  - c. **When battery pack is not in use, keep it away from other metal objects, like paper clips, coins, keys, nails, screws or other small metal objects, that can make a connection from one terminal to another.** *Shorting the battery terminals together may cause burns or a fire.*
  - d. **Under abusive conditions, liquid may be ejected from the battery; avoid contact.** *If contact accidentally occurs, flush with water. If liquid contacts eyes, additionally seek medical help. Liquid ejected from the battery may cause irritation or burns.*
  - e. **Do not use a battery pack or tool that is damaged or modified.** *Damaged or modified batteries may exhibit unpredictable behaviour resulting in fire, explosion or risk of injury.*
  - f. **Do not expose a battery pack or tool to fire or excessive temperature.** *Exposure to fire or temperature above 130 °C may cause explosion.*
  - g. **Follow all charging instructions and do not charge the battery pack or tool outside the temperature range specified in the instructions.** *Charging improperly or at temperatures outside the specified range may damage the battery and increase the risk of fire.*
- 6) Service**
- a. **Have your power tool serviced by a qualified repair person using only identical replacement parts.** *This will ensure that the safety of the power tool is maintained.*
  - b. **Never service damaged battery packs.** *Service of battery packs should only be performed by the manufacturer or authorized service providers.*



## WARNING!

Use only with SENIX X6 battery: B30X6/  
B40X6/B60X6/B80X6  
And chargers: CHX6-L-EU/CHQX6-EU/  
CHQX6-M-EU/CHDX6-M-EU.

## GRASS TRIMMER SAFETY WARNINGS

- a. Do not use the machine in bad weather conditions, especially when there is a risk of lightning. This decreases the risk of being struck by lightning.

- b. Thoroughly inspect the area for wildlife where the machine is to be used. Wildlife may be injured by the machine during operation.
- c. Thoroughly inspect the area where the machine is to be used and remove all stones, stick, wires, bones, and other foreign objects. Throwing objects can cause personal injury.
- d. Before using the machine, always visually inspect to see that the cutter or blade and the cutter or blade assembly are not damaged. Damaged parts increase the risk of injury.
- e. Follow instructions for changing accessories. Improperly tightened blade securing nuts or bolts may either damage the blade or result in it becoming detached.
- f. Wear eye, ear, head and hand protection. Adequate protective equipment will reduce personal injury by flying debris or accidental contact with the cutting line or blade.
- g. While operating the machine, always wear non-slip and protective footwear. Do not operate the machine when bare foot or wearing open sandals. This reduces the chance of injury to the feet from contact with the moving cutters or lines.
- h. While operating the machine, always wear long trousers. Exposed skin increases the likelihood of injury from thrown objects.
- i. Keep bystanders away while operating the machine. Thrown debris can result in serious personal injury.
- j. Always use two hands when operating the machine. Holding the machine with both hands will avoid loss of control.
- k. Hold the machine by the insulated gripping surfaces only, because the cutting line or blade may contact hidden wiring. Cutting line or blades contacting a "live" wire may make exposed metal parts of the machine "live" and could give the operator an electric shock.
- l. Always keep proper footing and operate the machine only when standing on the ground. Slippery or unstable surfaces may cause a loss of balance or control of the machine.
- m. Do not operate the machine on excessively steep slopes. This reduces the risk of loss of control, slipping and falling which may result in personal injury.
- n. When working on slopes, always be sure of your footing, always work across the face of slopes, never up or down and exercise extreme caution when changing direction. This reduces the risk of loss of control, slipping and falling which may result in personal injury.
- o. Keep all parts of the body away from the cutter, line or blade when the machine is operating. Before you start the machine, make sure the cutter, line or blade is not contacting anything. A moment of inattention while operating the machine may result in injury to yourself or others.
- p. Do not operate the machine above waist height. This helps prevent unintended cutter or blade contact and enables better control of the machine in unexpected situations.
- q. Maintain control of the machine and do not touch cutters, lines or blades and other hazardous moving parts while they are still in motion. This reduces the risk of injury from moving parts.
- r. Carry the machine with the machine switched off and away from your body. Proper handling of the machine will reduce the likelihood of accidental contact with a moving cutter, line or blade.
- s. Only use replacement cutters, lines, cutting heads and blades specified by the manufacturer. Incorrect replacement parts may increase the risk of breakage and injury.
- t. When clearing jammed material or servicing the machine, make sure the switch is off and the battery pack is removed. Unexpected starting of the machine while clearing jammed material or servicing may result in serious personal injury.

# SAFETY WARNINGS FOR BRUSH CUTTER & GRASS TRIMMER

## IMPORTANT READ CAREFULLY BEFORE USE KEEP FOR FUTURE REFERENCE

### 1) Training

- a. Read the instructions carefully. Be familiar with the controls and the correct use of the machine. Please use the machine properly; any unintended use may cause a danger to people.
- b. Never allow children, persons with reduced physical, sensory or mental capabilities or lack of experience and knowledge or people unfamiliar with these instructions to use the machine. Local regulations can restrict the age of the operator.
- c. Keep in mind that the operator or user is responsible for accidents or hazards occurring to other people or their property.
- d. National regulations may restrict the use of the machine.
- e. Keep other people including children, animals and bystanders outside the 15-meter hazard zone. Stop the machine immediately if you are approached.

### 2) Preparation

- a. While operating the machine always wear substantial footwear and long trousers. Do not operate the machine when barefoot or wearing open sandals. Avoid wearing clothing that is loose fitting or that has hanging cords or ties.
- b. Always inspect the tool before use, and after dropping or other impacts, check for sign of wear or damage and repair as necessary, especially the parts of the cutting head.
- c. Never operate the machine while people, especially children, or pets are nearby.
- d. Never operate the machine with damaged guards or shields or without guards or shields in place.
- e. When wearing a harness, no other wearable interferes with the release and removal of the harness. Do not simultaneously wear multiple belt harnesses or multiple shoulder harnesses.

### 3) Operation

- a. Avoid using the machine in bad weather conditions especially when there is a risk of lightning.
- b. Use the machine only in daylight or good artificial light.
- c. Switch on the motor only when the hands and feet are away from the cutting means.
- d. Always disconnect the machine from the power supply (i.e. remove the plug from the mains, remove the disabling device or removable battery). Make sure that cutting means have come to a complete stop.
  - Whenever the machine is left unattended;
  - Before clearing a blockage;
  - Before checking, cleaning or working on the machine;
  - After striking a foreign object;
  - Whenever the machine starts vibrating abnormally.
- e. Take care against injury to feet and hands from the cutting means.
- f. Always ensure that the ventilation openings are kept clear of debris.
- g. Keep proper balance and footing at all times. Do not overreach. Always be sure of your footing on slopes and walk, never run.
- h. If the machine breaks down, stop the machine and remove the plug from the socket. It must be repaired by the manufacturer or their service agent in order to avoid a hazard.
- i. The residual risks like noise, vibration, electromagnetic field, etc. remain despite the inherent safe design measures, safeguarding and complementary protective measures adopted.
- j. Secure the machine during transport to prevent damage or injury.
- k. Never operate the machine if you are tired, ill or under influence of alcohol, drugs and medicine.
- l. Avoid accidental starting. Keep your hands and fingers away from the switch lever while connecting extension leads or carrying the machine when connected to the supply. Keep hands and feet away from the cutting parts at all times and especially when switching on the motor.
- m. Keep the cutting head below waist level. Always cut from left to right so that debris is thrown away from you.
- n. Maintain a correct working posture. The operator must take a break and change working position after working for a long period. Keep a firm footing and balance

during operation; the harness must be used if it is provided.

- o. Never replace the non-metallic cutting means with metallic cutting means.

#### **4) Recommendation**

- a. Avoid using the machine in bad weather conditions especially when there is a risk of lightning.

## **EMERGENCY**

Familiarise yourself with the use of this product by means of this instruction manual. Memorise the safety directions and follow them to the letter. This will help to prevent risks and hazards.

1. Always be alert when using this product, so that you can recognise and handle risks early. Fast intervention can prevent serious injury and damage to property.
2. Switch off and disconnect from the power supply if there are malfunctions. Have the product checked by a qualified professional and repaired, if necessary, before you operate it again.

## **RESIDUAL RISKS**

Even if you are operating this product in accordance with all the safety requirements, potential risks of injury and damage remain. The following dangers can arise in connection with the structure and design of this product:

1. Health defects resulting from vibration emission if the product is being used over long periods of time or not adequately managed and properly maintained.
2. Injuries and damage to property due to broken cutting attachments or the sudden impact of hidden objects during use.
3. Danger of injury and property damage caused by flying objects.
4. Prolonged use of this product expose the operator to vibrations and may produce 'whitefinger' disease. In order to reduce the risk, please wear gloves and keep your hands warm. If any of the 'whitefinger' symptoms appear, seek medical advice immediately. 'Whitefinger' symptoms include: numbness, loss of feeling, tingling, pricking, pain, loss of strength, changes in skin colour or condition. These

symptoms normally appear in the fingers, hands or wrists. The risk increases at low temperatures.



## **WARNING!**

This product produces an electromagnetic field during operation! This field may under some circumstances interfere with active or passive medical implants! To reduce the risk of serious or fatal injury, we recommend persons with medical implants to consult their doctor and the medical implant manufacturer before operating this product!

## **SAVE THIS INSTRUCTIONS**

### **INTENDED USE**

This machine is used to cut grass, light weeds, and other similar vegetation at or around ground level. The cutting plane must be approximately parallel to the ground surface. You cannot use the machine to cut or chop hedges, shrubs, bushes, flowers and compost.

# KNOW YOUR UNIT

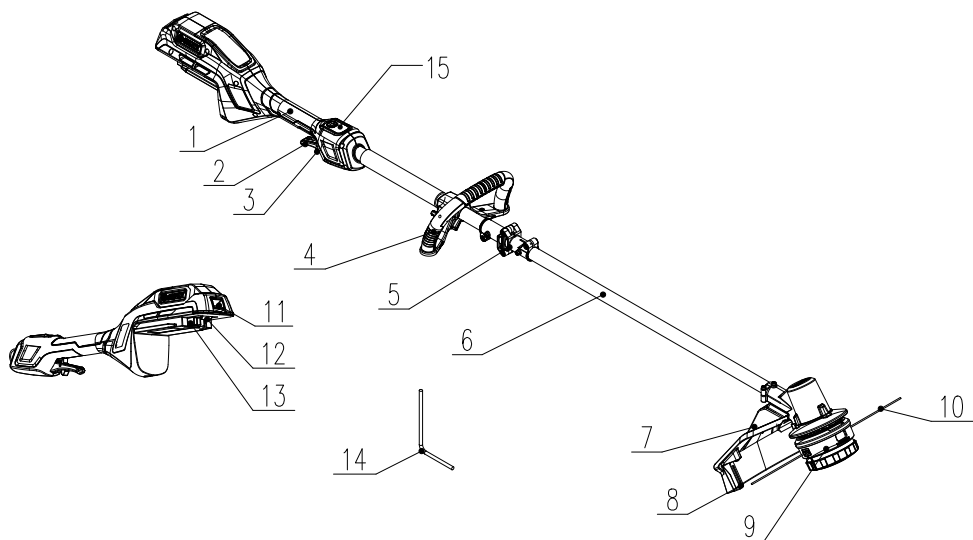

## APPLICATIONS

Model: GTX6-M-EU

As a Line Trimmer:

Cutting grass, light weeds, and other similar vegetation at or around ground level.

|    |                     |
|----|---------------------|
| 1  | Rear handle         |
| 2  | Trigger             |
| 3  | Safety Switch       |
| 4  | Front-Assist Handle |
| 5  | Coupler             |
| 6  | Tube                |
| 7  | Guard               |
| 8  | Cutting Blade       |
| 9  | Trimmer Head        |
| 10 | Cutting Line        |

|    |                        |
|----|------------------------|
| 11 | Battery-Release Button |
| 12 | Latch                  |
| 13 | Electric Contacts      |
| 14 | Inner Plum Wrench      |
| 15 | Control Panel          |



## SPECIFICATIONS

| Model   | GTX6-M-EU  |
|---|--|
| Input Voltage   | 56 V  (60 V Max*) |
| Rated Output Power  | 600 W  |
| No-Load Speed   | 5 000 RPM (ECO)<br>6 000 RPM (MAX)   |
| Cutting Capacity  | 40.6 cm  |
| Cutting Line Type   | 2.4 mm Nylon Twist Line  |
| Line Length   | 4 m  |
| Feeding System  | Bump Feed  |
| Recommended Operating Temperature                           | 0 °C-40 °C   |
| Recommended Storage Temperature                             | -20 °C-70 °C   |
| Vibration level   | <2.5 m/s <sup>2</sup>  |
| Measurement Uncertainty K                                   | 1.5 m/s <sup>2</sup>   |
| Sound pressure value L <sub>pA</sub>                        | 82 dB(A)   |
| Sound power value L <sub>WA</sub>                           | 89 dB(A)   |
| Measurement Uncertainty K <sub>pA</sub> and K <sub>WA</sub> | 3 dB(A)  |
| Weight (Tool Only)  | 3.4 kg   |

\*60V Max battery, maximum initial battery voltage (measured without a workload) is 60V. The nominal voltage is 56V.

## ASSEMBLY

1. Unpack all parts and lay them on a flat, stable surface:
2. Remove all packing materials and shipping devices, if applicable.
3. The scope of delivery varies depending on the country and purchased variant.  
Model GTX6-M-EU
  - Cordeless Line Trimmer x1
  - Guard x1
  - Front-Assist Handle x1
  - Inner Plum Wrench x1
  - Cutting Line x1
  - Screw x1
  - Instruction Manual x1
4. If you find that parts are missing or show damage do not use the product but contact your dealer. Using an incomplete or damaged product represents a hazard to people and property.
5. Ensure that you have all the accessories and tools needed for assembly and operation. This also includes suitable personal protective equipment.



### WARNING!



Wear protective gloves for this assembly work and always lay the product on a flat and stable surface while assembling.



Follow the assembly instructions step-by-step and use the pictures provided as a visual guide to easily assemble the product!  
Do not insert the battery pack before the power tool is completely assembled or adjusted!

## PRE-INSTALLING

1. Turn the tube straight.

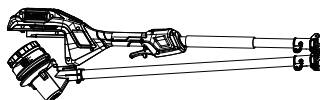

Fig. 1



## WARNING!

Do not squeeze the connecting wire during rotation.

2. Tighten the two screws at the coupler.

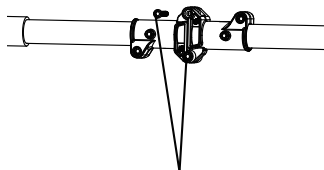

Fig. 2



Fig. 3



## NOTE:

One of the screws is pre-assembled at the coupler.

## INSTALLING GUARD



## WARNING!

Always wear gloves when mounting or replacing the guard. Take care of the blade on the guard and protect your hand from cutting.



## WARNING!

To prevent accidental starting that could cause serious personal injury, always remove the battery pack from the tool when installing the guard.



## WARNING!

Never operate the tool without the guard firmly in place. The guard must always be on the tool to protect the user! When the guard is secured, never attempt to remove or adjust the guard, if a replacement is needed, it should be performed by a qualified service technician.

### Guard

Reduces the risk of injury from foreign objects flung backwards toward the operator and from contact with the cutting attachment.

1. Push the guard to the end in the direction shown.

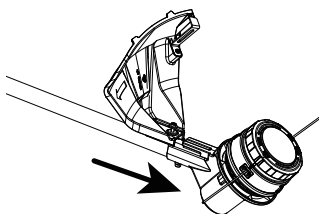

Fig. 4

2. Align the anti-loss screw, which is pre-assembled on the guard, with the screw hole in the housing. Then tighten the anti-loss screw.

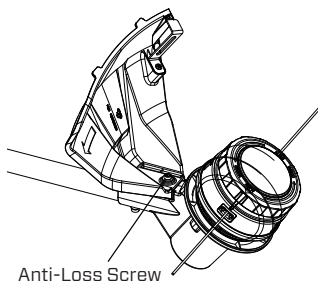

Fig. 5

## INSTALLING HANDLE



## WARNING!

To prevent accidental starting that could cause serious personal injury, always remove the battery pack from the tool when installing or adjusting the front-assist handle.



## WARNING!

The tool can not be used without the front-assist handle securely fixed.

1. Push the front-assist handle onto the tube.

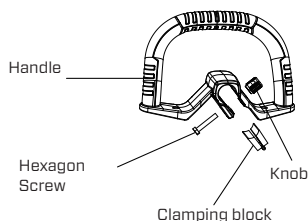

Fig. 6

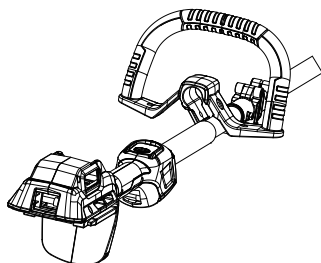

Fig. 7

2. Push the clamping block along the tube into the handle slot, mount the hexagon screw, and clamp them with the knob.

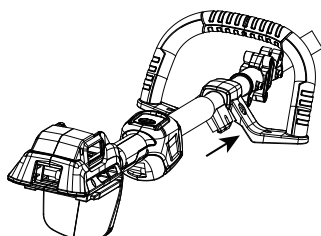

Fig. 8

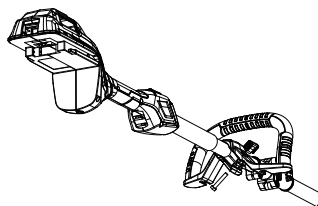

Fig. 9

3. The front-assist handle can be adjusted by loosening the knob to make sure your front arm is straight when using the trimmer and then tighten the knob.

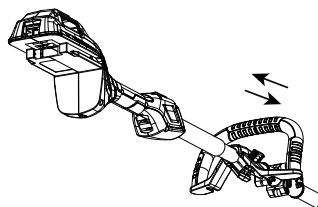

Fig. 10

## TRIMMER HEAD REPLACEMENT

### Trimmer head

Stores the cutting line and releases the cutting line when the head is lightly tapped on firm ground during operation.

1. Insert the inner plum wrench into the hole on the shield. Then slowly turn the trimmer head until the wrench is inserted into the blade.

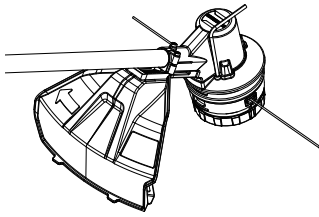

Fig. 11

2. Turn the trimmer head counterclockwise to remove the trimmer head.

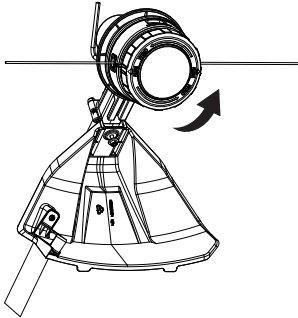

Fig. 12

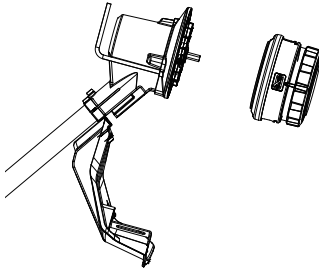

Fig. 13

3. Replace with a new trimmer head and install it in Step 1. Then turn the trimmer head clockwise until it is completely secured.

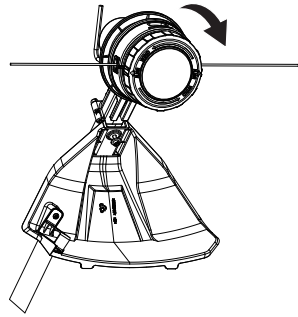

Fig. 14

## REMOVING EXCESS LINE

1. Press the two release-buttons and remove the lower cover assembly of the trimmer head by pulling it straight out.

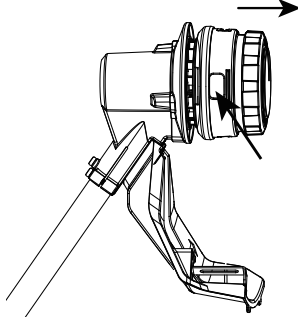

Fig. 15

2. Take the spool out of the trimmer head assembly.
3. Remove the cutting line from the spool.

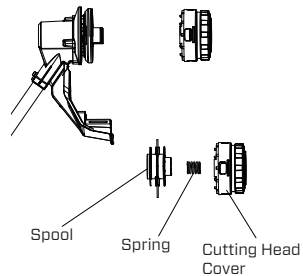

Fig. 16

4. Put spool back in place. Align the snap holes with the release-buttons to install the trimmer head assembly.

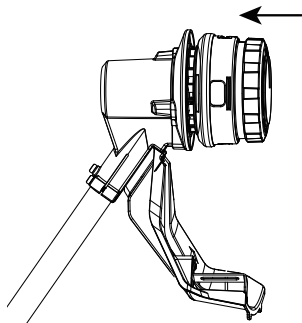

Fig. 17

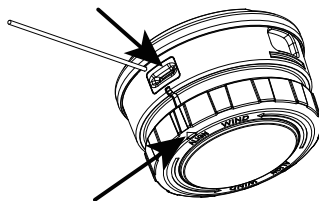

Fig. 18

4. Rotate the end cap in the direction of the long arrow to wind the line.

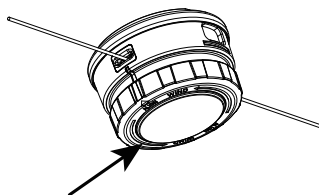

Fig. 19

## LINE REPLACEMENT



### WARNING!

Always use the recommended nylon cutting line with a diameter that does not exceed 2.4 mm. Using line other than that specified may cause the line trimmer to overheat or become damaged.



### WARNING!

Never use metal-reinforced line, wire, or rope, etc. These can break off and become dangerous projectiles.



### NOTE:

The Installation of cutting line is available in two types. You can choose to install the cutting line with or without removing the whole trimmer head.



### NOTE:

The spool is installed with a specific orientation. Rotate it slightly to make sure it snaps in place.

1. Align the small arrow on the end cap with the eyelet.
2. Cut one piece of cutting line (4m) long. Insert the line into the eyelet and push the line until the end of the line comes out of the opposite eyelet.
3. Pull the line from the other side until equal lengths of the line appear on both sides of the trimmer head.



### NOTE:

Watch the remaining line length carefully. Make sure the length of the line is about 10cm on each side.

## INSTALLING/REMOVING BATTERY PACK

### To install:

Align the battery ribs with the mounting slots and press the battery pack down until you hear a “click”.

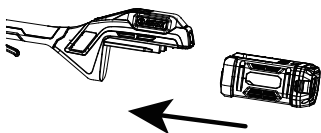

\_\_\_\_\_ Fig. 20 \_\_\_\_\_

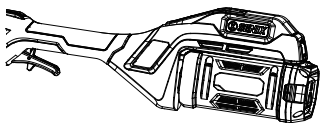

\_\_\_\_\_ Fig. 21 \_\_\_\_\_

#### To remove:

Depress the battery-release button and pull the battery pack out.

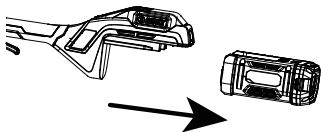

\_\_\_\_\_ Fig. 22 \_\_\_\_\_



#### NOTE:

Refer to the manuals for the charger and battery pack for more details about how the charger to charge the battery pack and other information regarding to the charger and battery pack.

## OPERATION



### WARNING!

Always wear enough protective equipments to reduce the risk of injury when operating this unit. Keep all parts of your body away from the cutting attachment and hot surfaces.



### WARNING!

Dress properly to reduce the risk of injury when operating this tool. Do not wear loose clothing or jewelry. Wear eye and ear/hearing protection. Wear heavy duty, long trousers, boots and gloves. Do not wear short trousers, sandals or go barefoot.

## HOLDING THE LINE TRIMMER

Before operating, hold the trimmer with both hands, one hand on the rear handle and the other on the front-assist handle which shall be straight. Then check for balanced footing and a proper cutting distance.



### NOTE:

The trimmer head is parallel to the ground at a proper cutting distance without the operator bending over.

## SWITCHING ON/OFF

### Safety switch

Helps to prevent accidental or unauthorized activating of the trigger. It must be depressed before the trigger can be activated.

### Trigger

Turns the line trimmer On and Off.

1. To start, push the safety switch forward then depress the trigger. You can choose to press ECO button to switch to economy mode.
2. To stop, release the trigger.

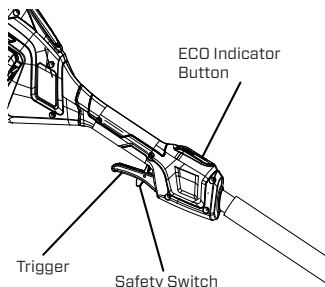

Fig. 23



## WARNING!

Always remove the battery pack from the line trimmer during work breaks and after finishing work.

## THE CONTROL PANEL

### BATTERY PACK POWER DISPLAY:

When the line trimmer is switched on/off, the battery pack power display will keep lighting for 5 seconds. When the battery pack is low voltage, the power display will flash.

### ECO INDICATOR:

Press the ECO indicator button and the indicator is on. If the trigger is not activated, the indicator will go out after keeping lighting for 5 seconds. If the trigger is activated, the indicator will keep lighting till the trigger is turned off.

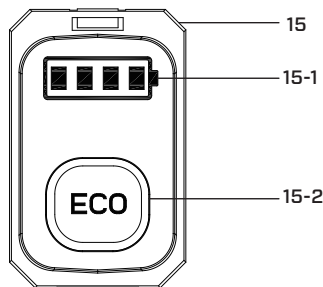

Fig. 24

|      |                            |
|------|----------------------------|
| 15   | Control panel              |
| 15-1 | Battery pack power display |
| 15-2 | ECO indicator              |

## USING THE LINE TRIMMER



## WARNING!

To avoid serious personal injury, wear goggles or safety glasses at all times when operating this unit. Wear a face mask or dust mask in dusty locations.



## WARNING!

Do not use any attachments or accessories not recommended by the manufacturer of this product. The use of attachments or accessories not recommended can result in serious personal injury.



## WARNING!

Keep hands and feet away from the cutting area.

Clear the area to be cut before each use. Remove all objects, such as rocks, broken glass, nails, wire, or line, that can be thrown or become entangled in the cutting attachment. Clear the area of children, bystanders, and pets. At a minimum, keep all children, bystanders and pets at least 15m away; there still may be risk to bystanders from thrown objects. Bystanders should be encouraged to wear eye protection. If you are approached, stop the motor and cutting attachment immediately.

### Before each use, check for damage/worn parts.

Check the bump head, guard and front-assist handle and replace the parts that are cracked, warped, bent, or damaged in any way.

The line-cutting blade on the edge of the guard can dull over time. It is recommended that you periodically sharpen it with a file or replace it with a new blade.



## WARNING!

Always wear gloves when mounting the guard or servicing the blade. Take care of the blade on the guard and protect your hand from cutting.



## WARNING!

Always stop and inspect the machine for damage upon striking a hard object or if there appears to be excessive vibration.



## WARNING!

Always turn off the tool and remove the battery pack when a blockage occurs.

**After each use, clean the trimmer.**



## WARNING!

Obstructions in the vents will prevent the air from flowing into the motor housing and result in overheating or damaged of the motor.

Use only mild soap and a damp cloth to clean the tool. Never let any liquid get inside the tool; never immerse any part of the tool into a liquid.

- Keep air vents in the motor housing from debris at all times.



## WARNING!

When clearing a blockage, always stop the trimmer, remove the battery, and remove the grass from the motor shaft and trimmer head.



## WARNING!

Never use water for cleaning your trimmer. Avoid using solvents when cleaning plastic parts. Most plastics are susceptible to damage from various types of commercial solvents. Use clean cloths to remove dirt, dust, oil, grease, etc.

### TIPS FOR BEST TRIMMING RESULTS

- The correct angle for the cutting attachment is parallel to the ground.
- Do not force the trimmer. Allow the very tip of the line to do the cutting (especially along walls). Cutting with more than the tip will reduce cutting efficiency and may overload the motor.

- The cutting height is determined by the distance of the cutting line from the lawn surface.
- Grass over 20cm should be cut by working progressively from top to the bottom in small increments to avoid premature line wear or motor drag.
- Slowly move the trimmer into and out of the area being cut, maintaining the cutting head position at the desired cutting height. This movement can be either a forward-backward motion or a side-to-side motion. Cutting shorter lengths produces best results.
- Trim only when grass and weeds are dry.
- Wire and picket fences can cause extra line wear or breakage. Stone and brick walls, curbs, and wood may wear line rapidly.
- Avoid trees and shrubs. Tree bark, wood moldings, siding, and fence posts can easily be damaged by the line.

## MAINTENANCE



## WARNING!

Remove and pull out the battery pack before maintenance! Wear protective gloves! Maintain this product regularly and carefully! If the product is improperly maintained, it may fail at its intended task, which may produce fatal consequences.



## WARNING!

To prevent any danger or defects, user should check and maintain every part of the machine before use and after dropping or other impacts. Improper maintenance can be harmful to you.



## WARNING!

Wear protective clothing and observe all safety instructions to prevent serious personal injury.

1. Keep the product clean. Remove debris from it after each use and before storage.
2. Regular and proper cleaning will help ensure safe use and prolong the life of the product.
3. Inspect the product before each use for worn and damaged parts. Do not operate it if you find broken and worn parts.





## WARNING!

Only perform repairs and maintenance work according to these instructions!

## MAINTENANCE OF BATTERY PACK

1. If the battery is empty and the product is switched off automatically, do not continue to press the switch trigger.
2. Charging the battery only after the battery pack is cooled down.
3. Charging the battery completely if the product will not be used for long time.
4. Charging the battery at least every 6 months to maintain the optimal capacity.

During the maintenance, users should take care of their safety. Always wear eye, hearing, hand, foot and body protection to reduce the risk of injury when operating this unit. And check the unit that it can work normally after the maintenance. If any deterioration occurs, follow the maintenance according to this instruction!

## CLEANING



## WARNING!

Always switch the product off, remove and pull out the battery pack from the product and let the product cool down before performing inspection, maintenance and cleaning work!

1. Use a small brush to clean the outside of the unit. Do not use strong detergents. Household cleaners that contain aromatic oils such as pine and lemon, and solvents such as kerosene, can damage plastic. Wipe off any moisture with a soft cloth.
2. Inspect the product before and after each use for worn and damaged parts. Do not operate it if you find worn and damaged parts.



## NOTE:

If the trimmer head is blocked by foreign objects during the operating, stop the product, wait for the trimmer head stops entirely, remove the foreign objects and clean the cutting blade.



## WARNING!

Only perform repairs and maintenance work according to these instructions!

## TRANSPORTATION

1. Clean the product as described above.
2. Always carry the product by its handle.
3. Protect the product from any heavy impact or strong vibrations which may occur during transportation in vehicles.
4. Secure the product to prevent it from slipping or falling over, damage or injury.

## STORAGE

1. Clean the product as described above.
2. Store the product and its accessories in a dark, dry, frost-free, well-ventilated place.
3. Always store the product in a place that is inaccessible to children.
4. We recommend using the original package for wstorage or covering the product with a suitable cloth or enclosure to protect it against dust.



## WARNING!

Installation, operation, or maintenance of the supported product should be carried out only be skilled persons.

## DISPOSAL

Waste product should not be disposed of with household waste. Please recycle where facilities exist. Check with your local authority or retailer for recycling advice. Users should clean up dust generated during operation to protect environment.



Electrical products should not be discarded with household products. Used electrical products must be collected separately and disposed of at collection points provided for this purpose. Talk with your local authorities or dealer for advice on recycling.

## TROUBLESHOOTING

Suspected malfunctions are often due to causes that the users can fix themselves. Therefore, check the product using this section. In most cases the problem can be solved quickly.

| Problem  | Possible Cause   | Solution   |
|--|--|--|
| Product does not start   | Battery pack not properly attached                                       | Attach properly  |
|  | Battery pack capacity too low  | Remove and charge battery pack   |
|  | Battery pack damaged   | Check by a specialist electrician  |
|  | Safety switch or trigger not set on ON position.                         | Refer to chapter "SWITCHING ON/OFF"  |
| Product does not reach full power  | Battery pack capacity too low  | Charge battery pack  |
|  | Air vents are blocked  | Clean the air vents  |
| Result is unsatisfactory   | Cutting attachment is worn   | Replace with a new one   |
| The line-cutting blade is not cutting the line.                                  | The line-cutting blade on the edge of the guard has become dull.         | Sharpen the line-cutting blade with a file or replace it with a new blade. |
| During line replacement, the line can't be loaded into the trimmer head properly | The line is not correctly inserted into the mounting hole in the eyelet. | Refer to chapter "LINE REPLACEMENT"  |
| Cutting line can no longer be fed  | Line inside the spool entangle   | Inspect the spool, rewind if necessary                                     |
|  | Spool empty  | Refill line spool  |



