

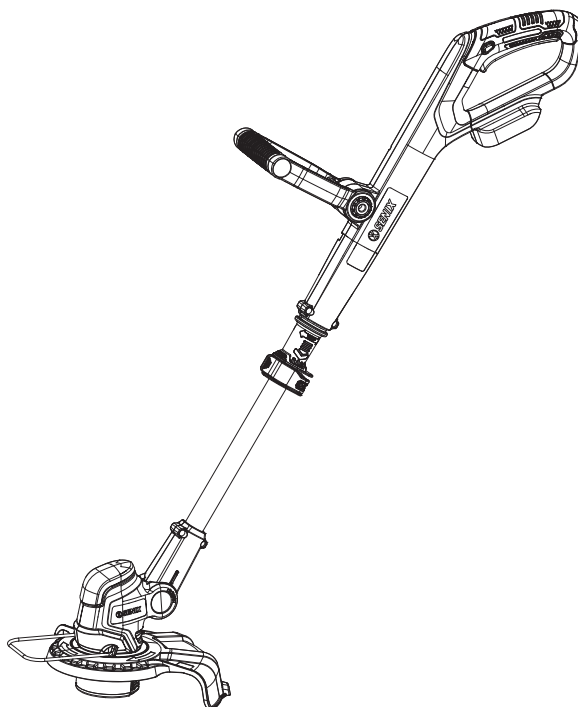

CORDLESS LINE TRIMMER



CAUTION: Before using this tool, please read this manual completely, and follow all operating safety measures.

- SAFETY
- ASSEMBLY
- OPERATION
- MAINTENANCE

Senix Australia Pty Ltd. 32/3 Westside Avenue, #Port Melbourne, Victoria, 3207
For customer support, please call 1300 461 825 or email us at info@senixtool.com

TABLE OF CONTENTS

SAFETY & INTERNATIONAL SYMBOLS.....	2
SAFETY INSTRUCTIONS.....	3
KNOW YOUR UNIT.....	7
SPECIFICATIONS.....	8
ASSEMBLY.....	8
OPERATION.....	9
MAINTENANCE.....	11
TROUBLESHOOTING.....	13

SAFETY & INTERNATIONAL SYMBOLS

Explanation of safety & international symbols describes safety and international symbols and pictographs that may appear on this product. Read the operator's manual for complete safety, assembly, operating and maintenance and repair information.



Caution / Warning.



To reduce the risk of injury, user must read instruction manual.



Wear eye protection.



Wear ear protection.



Do not expose to rain.



Wear protective gloves.



Wear sturdy, non-slip footwear.



Beware of foot injury by cutting attachment.



Keep bystanders away.



Do not dispose of battery packs in rivers or immerse in water.



Do not dispose of battery packs in fire. They will explode and cause injury.



Use and store the battery at a temperature below 50°C (122°F)



Do not disassemble, crush or expose to heat above 100°C (212°F); Never expose the battery to microwaves or high pressures.



WARNING – Disconnect battery before maintenance.



Waste electrical products should not be disposed of with household waste. Please recycle where facilities exist. Check with your Local Authority or local store for recycling advice.



Crossed out dust bin. Batteries and battery packs should not be disposed of with household waste. Please recycle where facilities exist. Check with your Local Authority or local store for recycling advice.



RCM Mark

SAFETY INSTRUCTIONS

GENERAL POWER TOOL SAFETY WARNINGS



WARNING!

Read all safety warnings, instructions, illustrations and specifications provided with this power tool. Failure to follow all instructions listed below may result in electric shock, fire and/or serious injury.

Save all warnings and instructions for future reference.

The term "power tool" in the warnings refers to your mains-operated (corded) power tool or battery-operated (cordless) power tool.

1. Work Area Safety

- a. **Keep work area clean and well lit.**
Cluttered or dark areas invite accidents.
- b. **Do not operate power tools in explosive atmospheres, such as in the presence of flammable liquids, gases or dust.**
Power tools create sparks which may ignite the dust or fumes.
- c. **Keep children and bystanders away while operating a power tool.**
Distractions can cause you to lose control of the tool or workpiece.

2. Electrical Safety

- a. **Power tool plugs must match the outlet. Never modify the plug in any way. Do not use any adapter plugs with earthed (grounded) power tools.** *Unmodified plugs and matching outlets will reduce risk of electric shock.*
- b. **Avoid body contact with earthed or grounded surfaces, such as pipes, radiators, ranges and refrigerators.**
There is an increased risk of electric shock if your body is earthed or grounded.
- c. **Do not expose power tools to rain or wet conditions.** *Water entering a power tool will increase the risk of electric shock.*
- d. **Do not abuse the cord. Never use the cord for carrying, pulling or unplugging the power tool. Keep cord away from heat, oil, sharp edges or moving parts.** *Damaged or entangled cords increase the risk of electric shock.*
- e. **When operating a power tool outdoors, use an extension cord suitable for outdoor use.** *Use of a cord suitable for*

outdoor use reduces the risk of electric shock.

- f. **If operating a power tool in a damp location is unavoidable, use a residual current device (RCD) protected supply.** *Use of an RCD reduces the risk of electric shock.*
- NOTE The term "residual current device (RCD)" can be replaced by the term "ground fault circuit interrupter (GFCI)" or "earth leakage circuit breaker (ELCB)".
3. **Personal Safety**
 - a. **Stay alert, watch what you are doing and use common sense when operating a power tool. Do not use a power tool while you are tired or under the influence of drugs, alcohol or medication.** *A moment of inattention while operating power tools may result in serious personal injury.*
 - b. **Use personal protective equipment. Always wear eye protection.** *Protective equipment such as a dust mask, non-skid safety shoes, hard hat or hearing protection used for appropriate conditions will reduce personal injuries.*
 - c. **Prevent unintentional starting. Ensure the switch is in the off-position before connecting to power source and/or battery pack, picking up or carrying the tool.** *Carrying power tools with your finger on the switch or energizing power tools that have the switch on invites accidents.*
 - d. **Remove any adjusting key or wrench before turning the power tool on.** *A wrench or a key left attached to a rotating part of the power tool may result in personal injury.*
 - e. **Do not overreach. Keep proper footing and balance at all times.** *This enables better control of the power tool in unexpected situations.*
 - f. **Dress properly. Do not wear loose clothing or jewelry. Keep your hair and clothing away from moving parts.** *Loose clothes, jewelry or long hair can be caught in moving parts.*
 - g. **If devices are provided for the connection of dust extraction and collection facilities, ensure these are connected and properly used.** *Use of dust collection can reduce dust-related hazards.*
 - h. **Do not let familiarity gained from**

frequent use of tools allow you to become complacent and ignore tool safety principles. *A careless action can cause severe injury within a fraction of a second.*

4. Power Tool Use And Care

- a. **Do not force the power tool. Use the correct power tool for your application.** *The correct power tool will do the job better and safer at the rate for which it was designed.*
- b. **Do not use the power tool if the switch does not turn it on and off.** *Any power tool that cannot be controlled with the switch is dangerous and must be repaired.*
- c. **Disconnect the plug from the power source and/or remove the battery pack, if detachable, from the power tool before making any adjustments, changing accessories, or storing power tools.** *Such preventive safety measures reduce the risk of starting the power tool accidentally.*
- d. **Store idle power tools out of the reach of children and do not allow persons unfamiliar with the power tool or these instructions to operate the power tool.** *Power tools are dangerous in the hands of untrained users.*
- e. **Maintain power tools and accessories. Check for misalignment or binding of moving parts, breakage of parts and any other condition that may affect the power tool's operation. If damaged, have the power tool repaired before use.** *Many accidents are caused by poorly maintained power tools.*
- f. **Keep cutting tools sharp and clean.** *Properly maintained cutting tools with sharp cutting edges are less likely to bind and are easier to control.*
- g. **Use the power tool, accessories and tool bits etc. in accordance with these instructions, taking into account the working conditions and the work to be performed.** *Use of the power tool for operations different from those intended could result in a hazardous situation.*
- h. **Keep handles and grasping surfaces dry, clean and free from oil and grease.** *Slippery handles and grasping surfaces do not allow for safe handling and control of the tool in unexpected situations.*

5. Battery Tool Use And Care

- a. **Recharge only with the charger specified by the manufacturer.** *A charger that is suitable for one type of battery pack may create a risk of fire when used with another battery pack.*
 - b. **Use power tools only with specifically designated battery packs.** *Use of any other battery packs may create a risk of injury and fire.*
 - c. **When battery pack is not in use, keep it away from other metal objects such as paper clips, coins, keys, nails, screws or other small metal objects that can make a connection from one terminal to another.** *Shorting the battery terminals together may cause burns or a fire.*
 - d. **Under abusive conditions, liquid may be ejected from the battery; avoid contact.** *If contact accidentally occurs, flush with water. If liquid contacts eyes, seek additional medical help. Liquid ejected from the battery may cause irritation or burns.*
 - e. **Do not use a battery pack or tool that is damaged or modified.** *Damaged or modified batteries may exhibit unpredictable behavior resulting in fire, explosion or risk of injury.*
 - f. **Do not expose a battery pack or tool to fire or excessive temperature.** *Exposure to fire or temperature above 100°C (212°F) may cause explosion.*
 - g. **Follow all charging instructions and do not charge the battery pack or tool outside the temperature range specified in the instructions.** *Charging improperly or at temperatures outside the specified range may damage the battery and increase the risk of fire.*
- 6. Service**
- a. **Have your power tool serviced by a qualified repair person using only identical replacement parts.** *This will ensure that the safety of the power tool is maintained.*
 - b. **Never service damaged battery packs.** *Service of battery packs should only be performed by the manufacturer or authorized service providers.*



WARNING!

Only use following batteries: B20X2/B25X2/B40X2/B50X2/B60X2/B80X2 and chargers: CHX2/CHQX2/CHQX2-M-EU/CHDX2-M-EU.

LAWN TRIMMER AND LAWN EDGE TRIMMER SAFETY WARNINGS

- a. **Do not use the machine in bad weather conditions, especially when there is a risk of lightning.** *This decreases the risk of being struck by lightning.*
- b. **Thoroughly inspect the area for wildlife where the machine is to be used.** *Wildlife may be injured by the machine during operation.*
- c. **Thoroughly inspect the area where the machine is to be used and remove all stones, sticks, wires, bones, and other foreign objects.** *Thrown objects can cause personal injury.*
- d. **Before using the machine, always visually inspect to see that the cutter and the cutter assembly are not damaged.** *Damaged parts increase the risk of injury.*
- e. **Before use, check the supply cord and any extension cord for signs of damage or aging. Do not use the machine if the cord is damaged or worn. If the cord is damaged or worn during use, switch off the machine and do not touch the cord before disconnecting it from the supply.** *A damaged supply cord or extension cord may result in electric shock, fire and/or serious injury.*
- f. **Keep guards in place. Guards must be in working order and be properly mounted.** *A guard that is loose, damaged, or is not functioning correctly may result in personal injury.*
- g. **Keep all cooling air inlets clear of debris.** *Blocked air inlets and debris may result in overheating or risk of fire.*
- h. **Wear eye protection and ear protection.** *Adequate protective equipment will reduce personal injury.*
- i. **While operating the machine, always wear non-slip and protective footwear. Do not operate the machine when barefoot or wearing open sandals.** *This reduces the chance of injury to the feet from contact with the moving cutter.*
- j. **Always wear clothing such as trousers that covers the operator's legs while operating the machine.** *Contact with the moving cutter or line may cause injury.*
- k. **Keep bystanders away while operating the machine.** *Thrown debris can result in*

serious personal injury.

- l. **Do not operate the machine above waist height.** *This helps prevent unintended cutter contact and enables better control of the machine in unexpected situations.*
- m. **Exercise caution when operating the machine in wet grass. Walk, never run.** *This reduces the risk of slipping and falling which may result in personal injury.*
- n. **Do not operate the machine on excessively steep slopes.** *This reduces the risk of loss of control, slipping and falling which may result in personal injury.*
- o. **When working on slopes, always be sure of your footing, always work across the face of slopes, never up or down and exercise extreme caution when changing direction.** *This reduces the risk of loss of control, slipping and falling which may result in personal injury.*
- p. **Keep all power cords and cables away from cutting area.** *Power cords or cables may be hidden in hedges or bushes and can be accidentally cut or damaged by the line or cutter.*
- q. **Keep all parts of the body away from the moving trimmer cutter or line. Do not clear material from the machine until it has been disconnected from the power source.** *The moving trimmer cutter or line may result in serious personal injury.*
- r. **Carry the machine with the machine switched off and away from your body.** *Proper handling of the machine will reduce the likelihood of accidental contact with a moving trimmer cutter or line.*
- s. **Only use replacement cutting heads and trimmer cutters or lines specified by the manufacturer. Do not replace the trimmer cutters or lines with metal wires or blades.** *Incorrect replacement parts may cause loss of control, breakage and injury.*

EMERGENCY

Familiarise yourself with the use of this product by means of this instruction manual. Memorise the safety directions and follow them to the letter. This will help to prevent risks and hazards.

- 1. Always be alert when using this product, so that you can recognise and handle risks early. Fast intervention can prevent serious injury and damage to property.

2. Switch off and disconnect from the power supply if there are malfunctions. Have the product checked by a qualified professional and repaired, if necessary, before you operate it again.

to be used in dry and well-illuminated conditions. Do not use it for other purposes. This product is intended for outdoor use only. Do not use it inside a building under any circumstances.

RESIDUAL RISKS

Even if you are operating this product in accordance with all the safety requirements, potential risks of injury and damage remain. The following dangers can arise in connection with the structure and design of this product:

1. Health defects resulting from vibration emission if the product is being used over long periods of time or not adequately managed and properly maintained.
2. Injuries and damage to property due to broken cutting attachments or the sudden impact of hidden objects during use.
3. Danger of injury and property damage caused by flying objects.
4. Prolonged use of this product expose the operator to vibrations and may produce 'whitefinger' disease. In order to reduce the risk, please wear gloves and keep your hands warm. If any of the 'whitefinger' symptoms appear, seek medical advice immediately. 'Whitefinger' symptoms include: numbness, loss of feeling, tingling, pricking, pain, loss of strength, changes in skin colour or condition. These symptoms normally appear in the fingers, hands or wrists. The risk increases at low temperatures.



WARNING!

This product produces an electromagnetic field during operation! This field may under some circumstances interfere with active or passive medical implants! To reduce the risk of serious or fatal injury, we recommend persons with medical implants to consult their doctor and the medical implant manufacturer before operating this product!

SAVE THIS INSTRUCTIONS

INTENDED USE

The 18V cordless line trimmer is only intended for cutting weed, grass or similar soft vegetation in domestic gardens. It is designed

KNOW YOUR UNIT

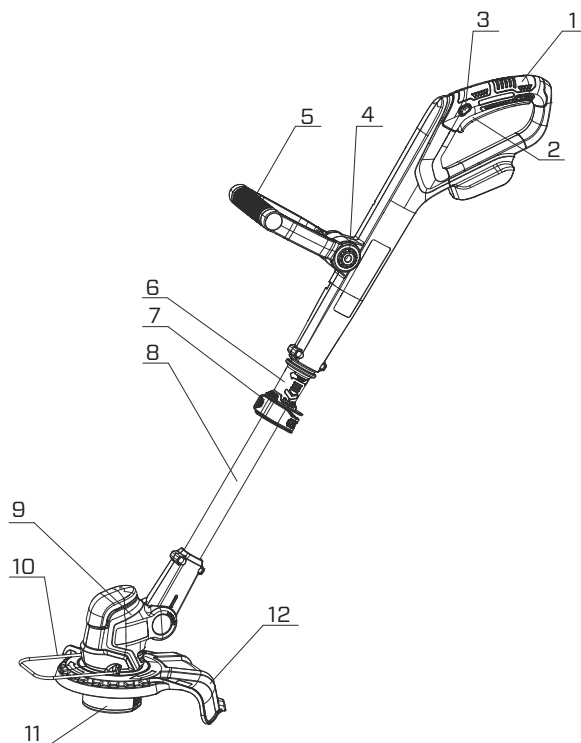

APPLICATIONS

Model: GTX2-M-EU

As a cordless line trimmer:

Cutting grass, weeds or soft vegetation in domestic garden.

1	Handle
2	Switch Trigger
3	Safety Switch
4	Auxiliary Handle Button
5	Auxiliary Handle
6	Pipe Sleeve

7	Telescoping Lock Clip
8	Aluminium Pipe
9	Motor Housing
10	Flower Protection
11	Trimmer Head
12	Guard

SPECIFICATIONS

Model	GTX2-M-EU
Rated voltage	18 V = (20 V = Max*)
No-load speed	8 500 rpm
Cutting line type	Nylon line
Cutting line diameter	1.6 mm
Cutting spool capacity	5 m
Cutting capacity	26 cm
Weight (tool only)	2.0 kg

*20V Max battery, maximum initial battery voltage (measured without a workload) is 20V. The nominal voltage is 18V.

ASSEMBLY

1. Unpack all parts and lay them on a flat, stable surface:
2. Remove all packing materials and shipping devices, if applicable.
3. The scope of delivery varies depending on the country and purchased variant.
Model of GTX2-M-EU
 - Cordless line trimmer x1
 - Auxiliary handle x1
 - Guard x1
 - Instruction manual x1
4. If you find that parts are missing or show damage do not use the product but contact your dealer. Using an incomplete or damaged product represents a hazard to people and property.
5. Ensure that you have all the accessories and tools needed for assembly and operation. This also includes suitable personal protective equipment.



WARNING!



Wear protective gloves for this assembly work and always lay the product on a flat and stable surface while assembling.



Follow the assembly instructions step-by-step and use the pictures provided as a visual guide to easily assemble the product! Do not insert the battery pack before the power tool is completely assembled or adjusted!

INSTALLING THE AUXILIARY HANDLE

1. Keep the auxiliary handle button being pressed, fix the auxiliary handle to the trimmer.
2. Release the button until achieve you satisfied position.
3. Make sure the auxiliary handle is well engaged before next step.

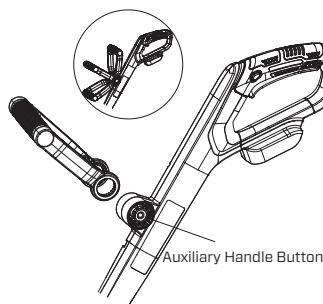

Fig. 1

INSTALLING THE GUARD



WARNING!

To reduce the risk of injury to persons, do not operate without guard in place.

1. Align the first arrow on the guard with the arrow on the trimmer head, put them together.
2. Rotate the guard clockwise until the second arrow on the guard matches the arrow on the trimmer head.
3. Check for the fitting condition between two surfaces.

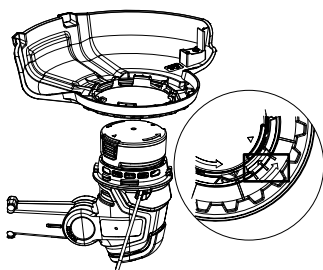

Fig. 2

INSTALLING/REMOVING THE BATTERY PACK

To install:

Slide the battery pack into the battery docking port on the product until it clicks.

To remove:

Press the battery-release button on the battery pack and slide the battery pack out.

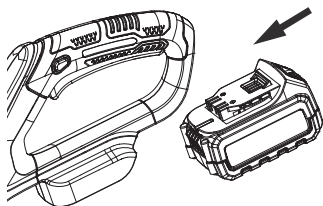

Fig. 3

OPERATION

! WARNING!

Inspect the tool for complete installation. Any missing, damaged or misplaced may cause serious injury.

Wear eye protection, long trousers and stout shoes at all times while operating the power tool.

SWITCHING ON/OFF

1. Keep the safety switch being pressed at first. Then press the switch trigger to switch the product on.

Release the safety switch once the product is running.

2. Release the switch trigger to switch the product off.

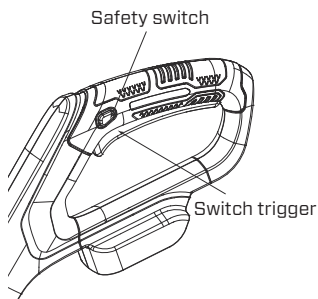

Fig. 4

ADJUSTING THE LENGTH OF PIPE

1. Unlock the telescoping lock clip and stretch the aluminium pipe to your desired length.
2. Lock again when finishing your adjustment.

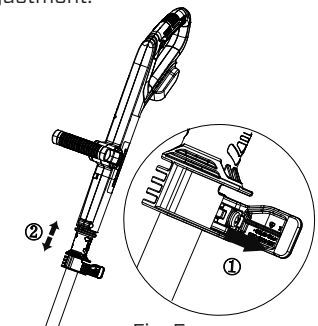

Fig. 5

ADJUSTING ANGLE OF TRIMMER HEAD

1. Keep pressing the angle adjustment button, hold the body of trimmer and lead it to ideal position. Judge the well engagement from a sound of "click".
2. Five optional angles (0-60°) set for meeting your using requirement.

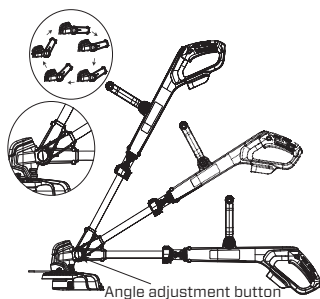

Fig. 6

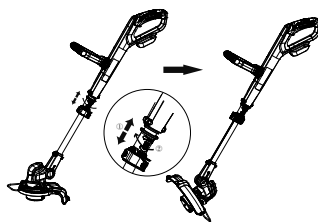

Fig. 8

USING THE FLOWER PROTECTION

Switch the flower protection to the working state by pulling down and clamping it into slot. When the flower protection is not in use, reset it upside.

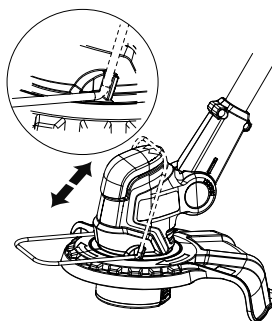

Fig. 7

EDGING TRIMMING



WARNING!

Risk of Eye Injury. Use Safety Glasses or Similar Eye Protection.

1. Stretch the pipe sleeve and rotate 180° clockwise.
2. It will be automatically locked when arrives at the angel of 180°. Then you can begin edging trimming.
3. On the contrary, pull the pipe sleeve again and rotate 180° counterclockwise back to normal trimming.

GENERAL TRIMMING INSTRUCTIONS

Stand in the operating position. Stand up straight. Do not bend over. Keep feet apart and firmly planted.

Move the trimmer left and right, keeping it well away from the body. Cut all grass from top to down.

Inspect the working area and remove all debris that may be entangled in the trimmer head. Also remove any objects that product may throw during cutting.

If the trimmer head is wrapped around with grass, stop the trimmer and clean up.

Avoid trees, flowers, stones, walls and other objects which can cause the line to break.

Check and feed the line regularly to maintain full cutting width and performance.

Some line breakage will occur from:

- Entanglement with foreign matter
- Normal line fatigue
- Attempting to cut thick vegetation
- Forcing the line into objects such as walls or fence posts

LINE FEEDING

1) Semi-automatic Line Feeding

The trimmer is equipped with a semi-automatic feeding system. The system feeds line with every press of the switch trigger.

2) Manual Line Feeding

Press the line-feed button and adjust the line to desired length.

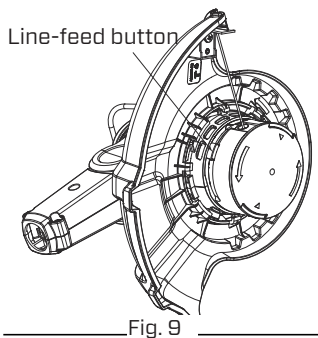

Fig. 9

OVERHEAT PROTECTION

When the tool/battery is overheated, the tool stops automatically. In this situation, let the power tool/battery cool before turning the tool on again.

OVERDISCHARGE PROTECTION

When the battery capacity is not enough, the tool stops automatically. In this case, remove the battery from the tool and charge the battery.

MAINTENANCE



WARNING!

Remove the battery pack before maintenance! Wear protective gloves and clothing! Always wear protective equipments such as gloves and eye protections to reduce the risk of injury when operating this unit.

Only perform repairs and maintenance work according to these instructions! All further works must be performed by a qualified specialist!

When servicing use only identical replacement parts. Use of any other accessory or attachment may increase the risk of injury.

WINDING UP THE CUTTING LINE

1. Remove the battery before replacing the spool.
2. Press both latches of the spool cover

together and remove the spool cover. Afterwards, remove the empty spool.

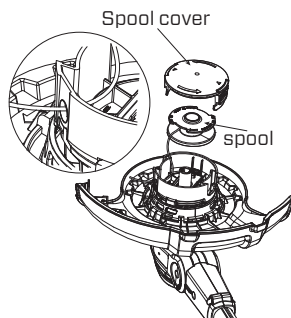

Fig. 10

3. Select a line of approx. 5m for refilling the spool.
4. Slide one end of the cutting line approx. 5-10mm into the hole for line wind-up in the spool.

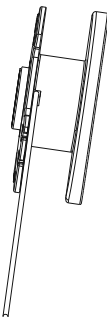

Fig. 11

5. Wind up the cutting line uniformly and tightly following the direction indicated by the arrow on spool.

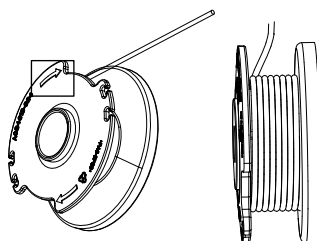

Fig. 12

6. Slide the other end of the cutting line through the hole for line guiding in the trimmer head.
7. Mount the spool back into the trimmer head and straighten the line. Affix the

spool by reinstalling the spool cover at last.



NOTE:

Only use cutting line consistent with "SPECIFICATION" for replacement.

CLEANING

- Switch the product off, pull out the battery pack from the product.
- Use a small brush to clean the outside of the unit. Do not use strong detergents. Household cleaners that contain aromatic oils such as pine and lemon, and solvents such as kerosene, can damage plastic.
- Wipe off any moisture with a soft cloth.



NOTE:

If the trimmer head is blocked by foreign objects during operation, stop the product, wait till the product stops entirely, then remove the foreign objects and clean the trimmer head. Clean moving parts may result in hazardous injury.

TRANSPORTATION

- Clean the product as described above.
- Always carry the product by its handle.
- Protect the product from any heavy impact or strong vibrations which may occur during transportation in vehicles.
- Secure the product to prevent it from slipping or falling over, damage or injury.

STORAGE

- Clean the product as described above.
- Store the product and its accessories in a dark, dry, frostfree, well-ventilated place.
- Always store the product in a place that is inaccessible to children. The ideal storage temperature is between 10°C and 30°C.
- We recommend using the original package for storage or covering the product with a suitable cloth or enclosure to protect it against dust.



NOTE:

To prolong battery life, never store battery

pack in a completely discharged condition. Make sure the battery pack is charged every six months or when the LED indicator shows only one light.

DISPOSAL

Unwanted product should not be disposed of with household waste. Please recycle where facilities exist. Check with your local authority or retailer for recycling advice. Users should clean up grass generated during operation to protect environment.



Electrical products should not be discarded with household products. Used electrical products must be collected separately and disposed of at collection points provided for this purpose. Talk with your local authorities or dealer for advice on recycling.

TROUBLESHOOTING

Suspected malfunctions are often due to causes that users can fix themselves. Therefore, troubleshoot the product using this section. In most cases the problem can be solved quickly.

PROBLEM	POSSIBLE CAUSE	SOLUTION
Product does not start	Battery pack not properly attached	Attach properly
	Battery too hot/cold	Allow to cool/warm
	Battery pack discharged	Charge the battery pack
Product does not cut	Cutting line too short/broken off	Manually feed cutting line
	Spool empty	Replace line spool
Cutting line can no longer be fed	Line inside the spool entangled	Inspect the spool, rewind if necessary
	Spool empty	Refill line spool
Cutting line breaks frequently	Line inside the spool entangled	Remove spool - rewind line
	Trimmer used incorrectly	Only trim with the tip of the line, avoid stones, walls and other hard objects. Feed the line regularly to maintain full cutting diameter.
Heavy vibrations	Cutting line broken	Pull out cutting line with manual feed
	Cutting system damaged	Have the product repaired by a qualified service.
	Grass between spool housing and line-feed button	Disassemble spool cover and remove grass
	Grass in hole for line feed	Remove grass from hole for line feed

